

Installing TouchView Mobile on iPhone

Go to the app store and download TouchView Mobile by Salient Systems.

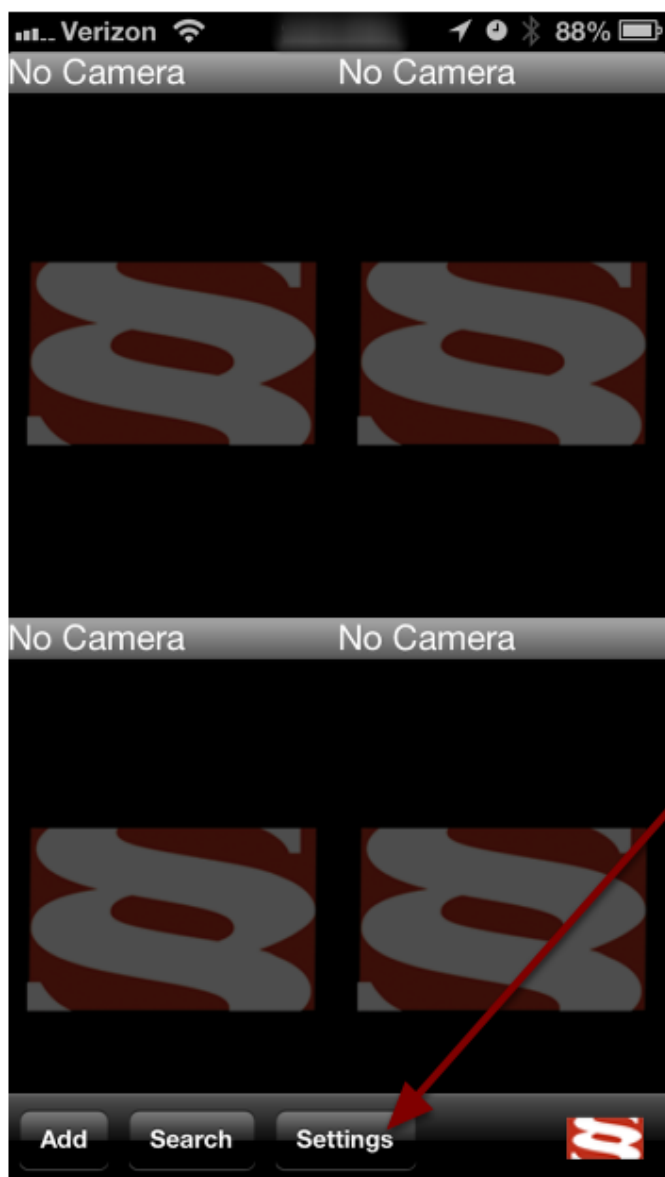

When you open TouchView the first time, you will need to manually add server information. Make sure you have the information provided to you by your sales representative in order to complete the login. Your screen should look like this:



Click "Settings"

If you don't see these buttons at the bottom of the screen, touch anywhere on the screen and they will appear.

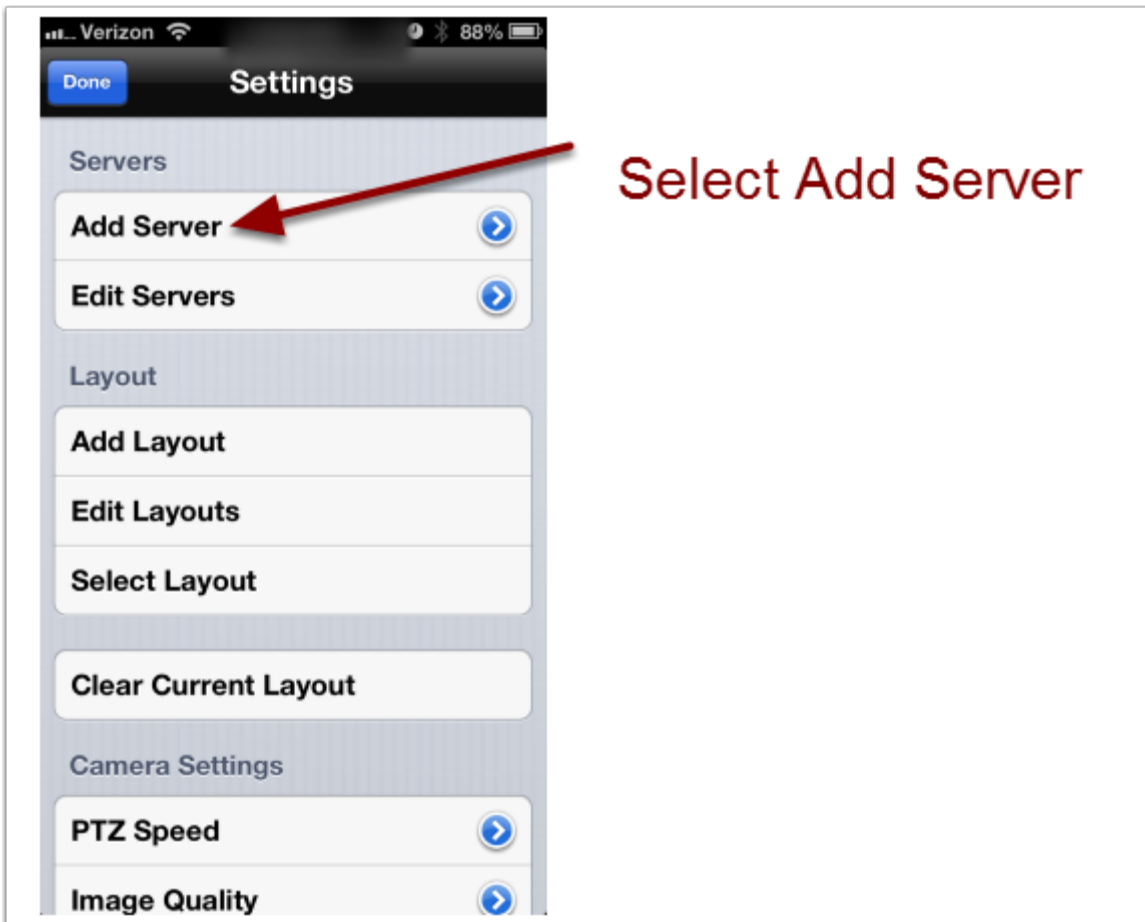

Click "done" after entering the text and the keyboard will go away. Now hit "Save" in the upper right corner. If everything is entered correctly you will get the message shown below: "Server added successfully."

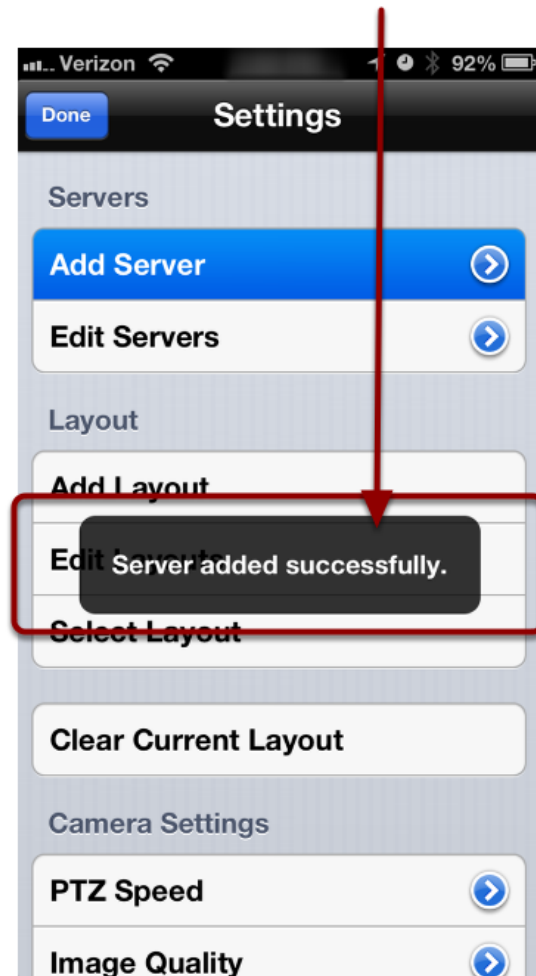

If you don't receive the confirmation message above, more than likely your user name or password may have been mis-entered.



Next click on Edit Layouts

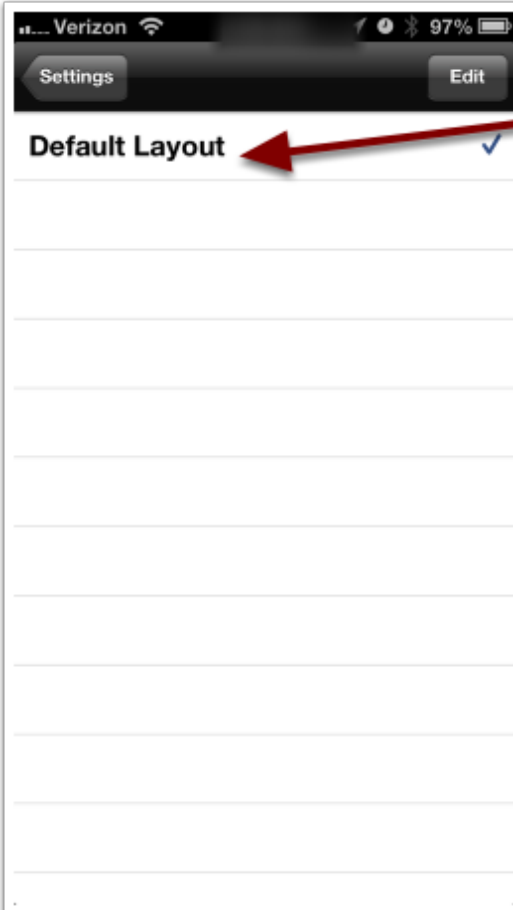

Click on Default Layout

Select a layout based on the number of cameras you have in your kit(s)

Select for 1 or 2

Select for 3 to 4



Click Save after making selection

Click Settings

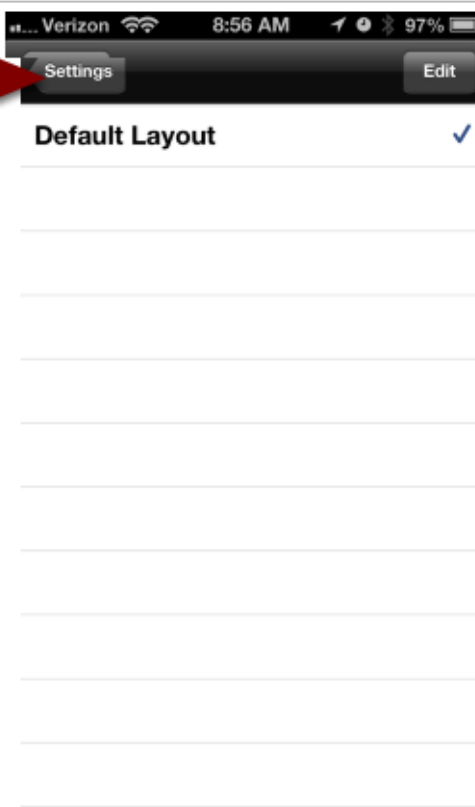

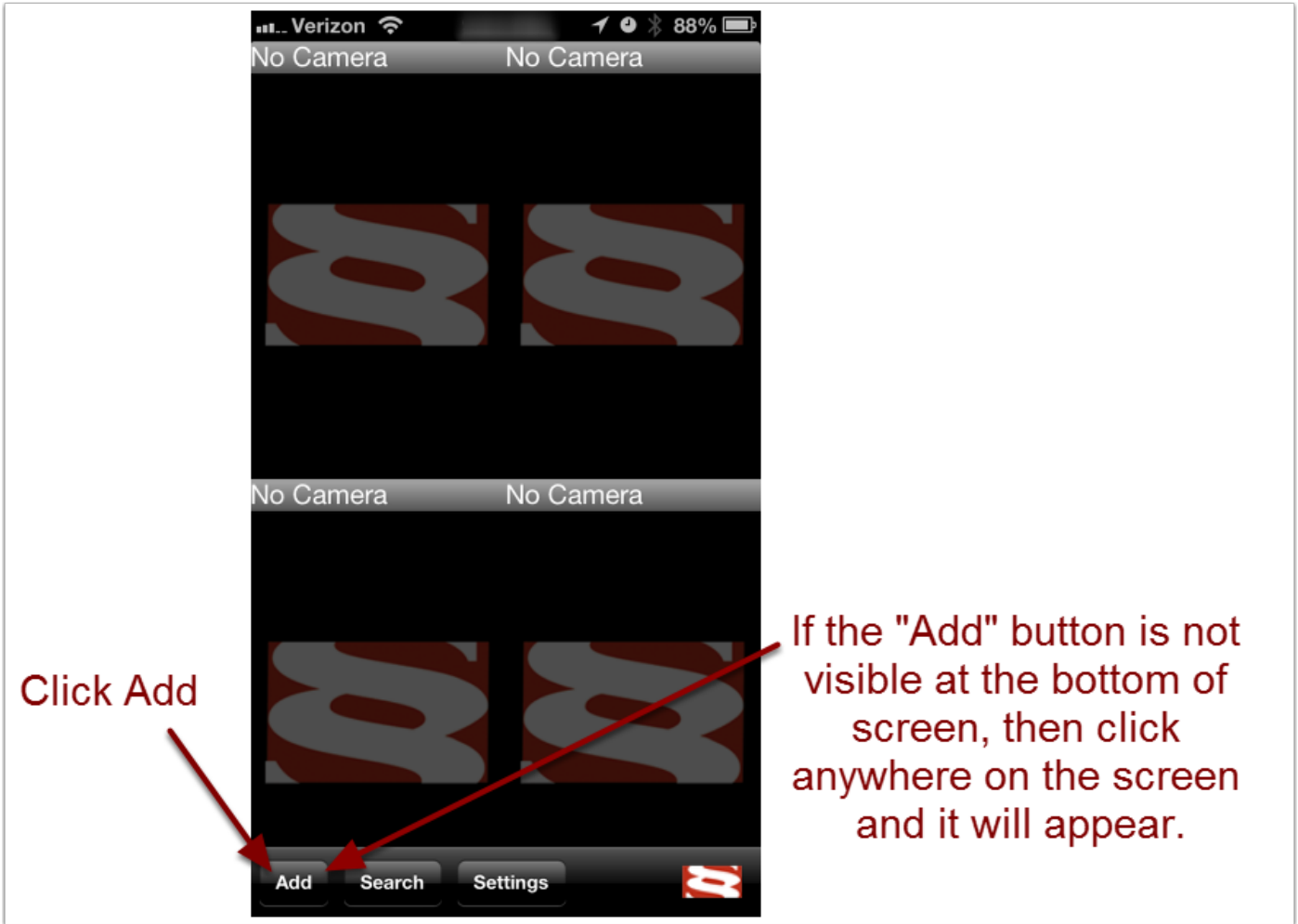

Click Add

If the "Add" button is not visible at the bottom of screen, then click anywhere on the screen and it will appear.

Select your Server
(it should be the only server
listed and will vary based on
your kit name)

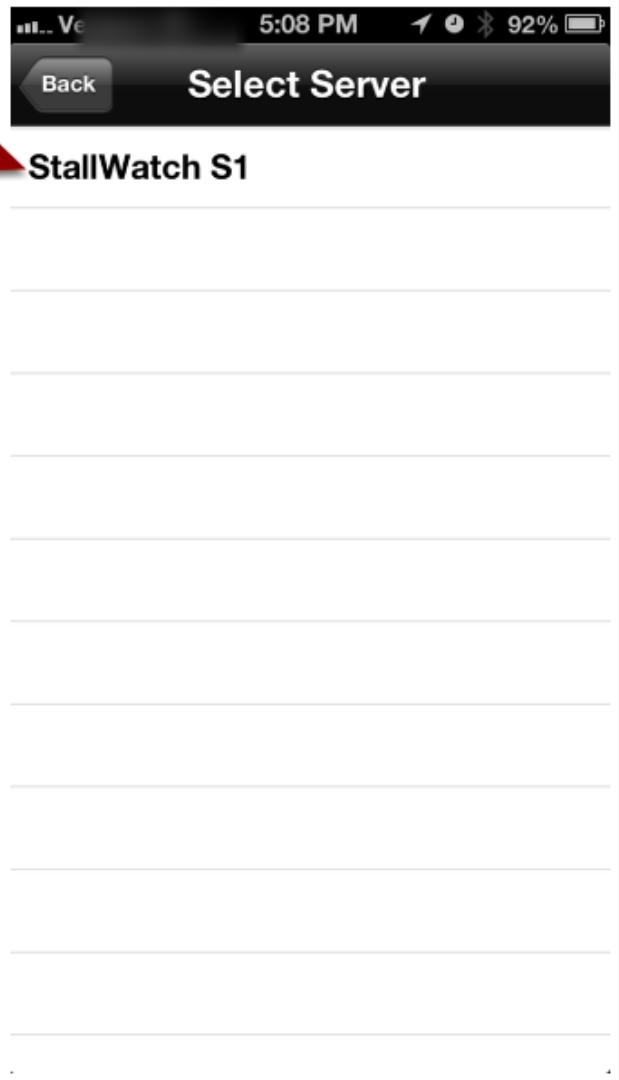

Click on each camera
one at a time to
select for viewing.
When selected the
camera will highlight
blue with a checkbox
as seen here.

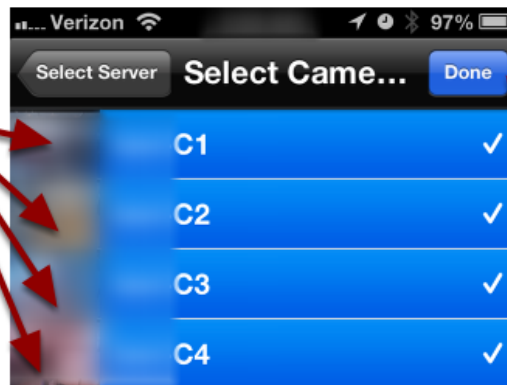

After
selecting all
cameras,
click Done

Now you will click in the center of each camera window one at a time to add your selected cameras.

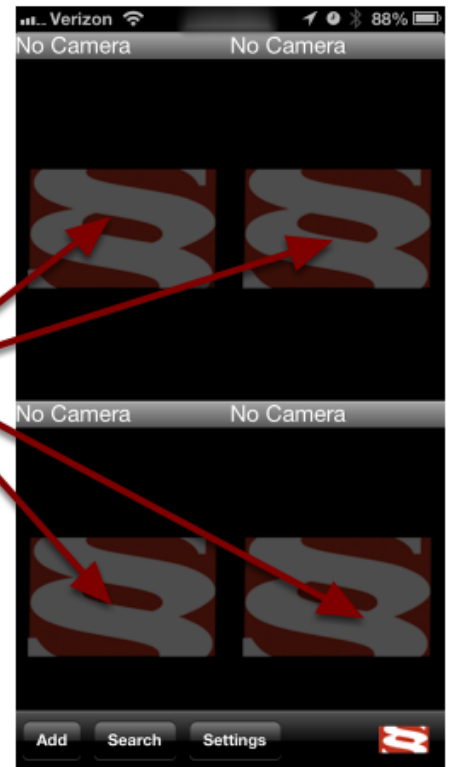

After a few seconds, your cameras will appear. Now you will only need to launch the app to see the cameras.

Advanced Settings:

The default settings is to low quality viewing to save your mobile bandwidth. It is possible to set the quality to "medium" or "high" if you have are using 4G or WiFi. Here is how: Tap the screen to get the "settings" button to appear at the bottom:

Under "Settings" scroll down and choose "Image Quality" and you will see "low" "medium" and "high". Choose this based on your preference and connection. Under "Frame Rate" you should choose "Medium(5 FPS)".

To view a single camera full screen, tap on the center of the camera window once. To return back to your multi-view, tap on the center of the full screen window once. Long press in the center of a window to bring up options for search, snapshot and light controls.